

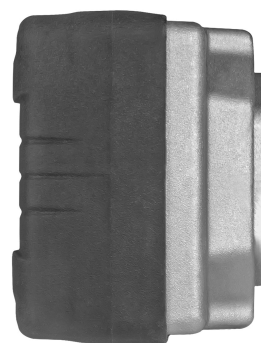

**DIGITAL GREASE INLINE METER. 1/8" (F) BSP 2500  
GR/MIN 70 (700) MPA (BAR)**

## DIGITAL GREASE INLINE METER. 1/8" (F) BSP 2500 GR/MIN 70 (700) MPA (BAR)

Equipped with current dispense display and resettable trip meter and non-resettable totalisers. Digital display powered by two 1,5 V AAA batteries. Accuracy +/- 2 %. Can be calibrated.



### TECHNICAL DATA

Part No	2168600
Capacity	2500 gr/min
Maximum working pressure	70 (700) MPa (bar)
Connection	1/8" (F) BSP
H.S. Code	90261021



## EUROLUBE EQUIPMENT

by Alentec & Orion AB, Grustagsvägen 4, SE-138 40 Älta, Sweden

EMAIL [eurolube@alentec.se](mailto:eurolube@alentec.se)

PHONE +46 (0)8-747 67 10

FAX +46 (0)8-715 20 74

 [www.eurolube.com](http://www.eurolube.com)

## RELATED PRODUCTS

**26716**

GREASE GUN WITH OUTLET TUBE



**26715**

DIGITAL GREASE METER WITH GREASE GUN



## EUROLUBE EQUIPMENT

by Alentec & Orion AB, Grustagsvägen 4, SE-138 40 Älta, Sweden

EMAIL [eurolube@alentec.se](mailto:eurolube@alentec.se)

PHONE +46 (0)8-747 67 10

FAX +46 (0)8-715 20 74

 [www.eurolube.com](http://www.eurolube.com)